

SECTION A-A

CENTRAL CABLE PULL

WABASH  
THROTTLE POSITION SENSOR  
ON LEFT HAND SIDE

1/8" BSP X 5/16"  
HOSE TAIL  
VACUUM FITTINGS  
SUPPLIED IF REQUIRED

PLUG IN M442 ECU

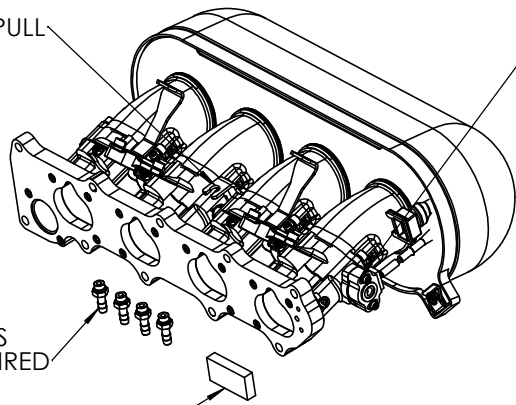

NOTE:  
FOR HEAD FLANGE AND PORT DETAILS  
REFER TO THE THROTTLE PACKAGE DRAWING  
102-102-00148



COPYRIGHT (c) 2013  
AT POWER LTD  
UNIT 9, CHESTNUT DRIVE, WYMONDHAM,  
NORFOLK, UK, NR18 9SB

UNLESS OTHERWISE STATED:  
DIMENSIONS IN MILLIMETRES  
TOLERANCES: LINEAR  $\pm 0.1$  ANGULAR  $\pm 0.5^\circ$   
SURFACE FINISH  $\sqrt{\text{A}} = \sqrt{\text{A}}$   
DRAWING STANDARDS TO ATQS 6003  
DATE FORMAT: DD/MM/YY

THIS DESIGN IS THE PROPERTY OF  
AT POWER THROTTLES LTD AND  
MUST NOT BE REPRODUCED OR  
COMMUNICATED WITHOUT  
AUTHORITY

CAD PLOT  
DO NOT  
SCALE

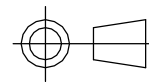

THIRD ANGLE PROJECTION

SCALE  
1:3

WEIGHT  
7466.666g

DRAWN - S.HOW

DATE - 16/12/22

CHECKED - S.HOW

APPROVED - A.CLIFTON

MATERIAL

SEE COMPONENT PARTS

FINISH

SEE COMPONENT PARTS

DRAWING TITLE

ASSY - HONDA F20/S2000 -  
CABLE PULL - WITH ME442  
ECU - PACKAGE

DRAWING NUMBER

102-102-00415

SHEET 2 OF 2 A3