

AT Power Throttles Ltd

Unit 9, Chestnut Drive
Wymondham,
Norfolk
NR18 9SB

Tel: +44 (0)1953 857800
Email: info@atpowerthrottles.com
Web: www.atpowerthrottles.com



Porsche 911 & 964 brake boost and/or cold idle control

**BRAKE BOOST IS REQUIRED FOR HYDRAULIC ASSISTED BRAKES.
I.A.C CONTROL IS REQUIRED FOR COLD IDLE CONTROL FOR USE WITH EMERALD ECU KIT AND A.T.POWER SUPPLIED MOTEC ECU KIT.
ASSEMBLY COMES WITH ALL COMPONENTS TO PROVIDE 3 SET UP OPTIONS.**

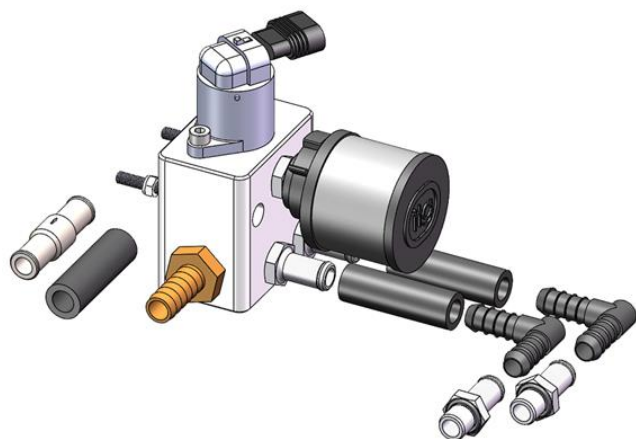

SET UP WITH IAC CONTROL AND BRAKE BOOST

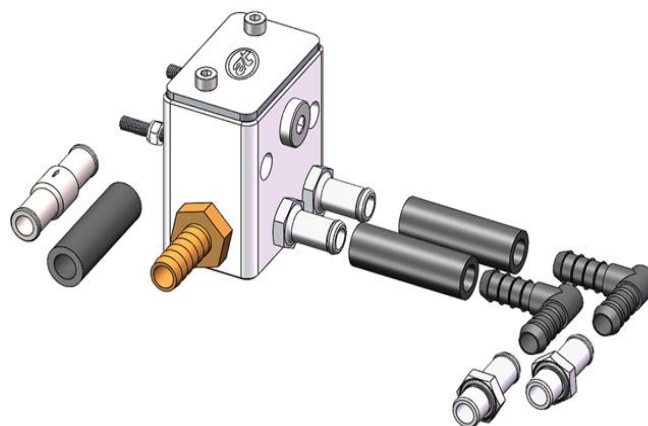

SET UP WITH BRAKE BOOST ONLY

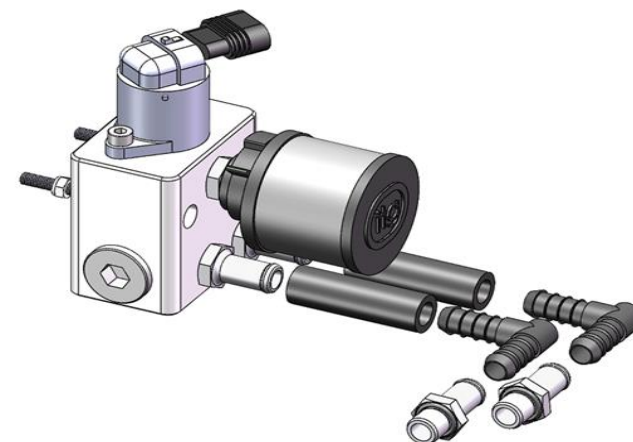

SET UP WITH I.A.C CONTROL ONLY

We reserve the right to make technical changes or modify the contents of this document without prior notice. With regards to purchase orders, the agreed particulars shall prevail. AT Power does not accept any responsibility whatsoever for potential errors or possible lack of information in this document.